

RESOLUTION NO. 1954

A RESOLUTION OF THE CITY COUNCIL OF THE CITY OF SOLEDAD
 SUBMITTING AN APPLICATION TO THE LOCAL AGENCY FORMATION
 COMMISSION ("LAFCO") TO TAKE PROCEEDINGS TO APPROVE
 THE PROPOSED CORRECTIONAL TRAINING FACILITY
 ("C.T.F") REORGANIZATION INVOLVING THE
 ANNEXATION OF THE CALIFORNIA CORRECTIONAL
 TRAINING FACILITY TO THE CITY OF SOLEDAD
 AND DETACHMENT OF THE SAME FROM THE
 GABILAN-SANTA LUCIA RESOURCE
 CONSERVATION DISTRICT AND
 THE SOLEDAD/MISSION
 RURAL FIRE
 PROTECTION
 DISTRICT

WHEREAS, The City of Soledad desires to initiate preceding pursuant to the Cortese-Knox Local Government Reorganization Act, Section 56800, of the State of California Government Code, for a reorganization of the territory consisting of the annexation of approximately a 997 acre site to the City of Soledad and detachment of the same 997 acres from the Gabilan-Santa Lucia Conservation District and the Mission Rural Fire District; and

WHEREAS, the Soledad City Council has requested the Monterey County LAFCO to amend the City's sphere of influence amendment to include said 997 acres; and,

WHEREAS, The City of Soledad has conducted proceedings to designate the area on the City's General Plan land use map and to include it within the Sphere of Influence in accordance with the requirements of Section 65350, et sequens, of the Government Code.

WHEREAS, The City of Soledad has conducted proceedings to Prezone the area to P-F (Public Facility) in accordance with the requirements of Sections 65353 to 65857, inclusive of the Government Code.

NOW, THEREFORE, BE IT RESOLVED by the City Council of the City of Soledad as follows:

Section 1. The City Council requests that the Monterey County Local Agency Formation Commission take proceedings for the reorganization involving the annexation to the City of Soledad 997 acres owned by the State of California

known as the Correctional Training Facility and detachment of the same 997 acres from the Gabilan-Santa Lucia Resource Conservation District and the Mission Soledad Rural Fire District, as shown on Exhibit "A", attached and incorporated herein by reference, in the manner provided by the Cortese-Knox Local Government Reorganization Act.

Section 2. The reasons for said request are as follows:

1. The City has amended the General Plan Land Use Map, designating the California Correctional Training Facility (Soledad) as Public/Quasi-Public and adding the Facility to the City's Sphere of Influence.
2. The City has amended the General Plan Land Use Element Text to read for Public and Quasi-Public Facilities: These include government buildings, libraries, churches, hospitals, schools and property owned or operated by Public Agencies for public purposes.
3. The State of California has adopted legislation (Section 56111.1) of the Government Code that allows the City of Soledad to annex the State property as a noncontiguous annexation.
4. A Negative Declaration for the proposed General Plan Amendment has been prepared and was posted on November 21, 1989.
5. The proposal is consistent with the existing, revised General Plan policies and programs.
6. The proposal will not effect air quality in the air basin and will not increase the potential for additional air pollution.
7. The proposal will not be detrimental to the public's health, safety, and welfare.

PASSED AND ADOPTED at a regular meeting of the City Council of the City of Soledad duly held on the 12th day of December, 1989, by the following vote:

AYES, and in favor thereof, Councilmembers: Campos,
Holguin, Ledesma, Mayor Pro Tem Untalon, Mayor Ortiz
NOES, Councilmembers: None
ABSENT, Councilmembers: None

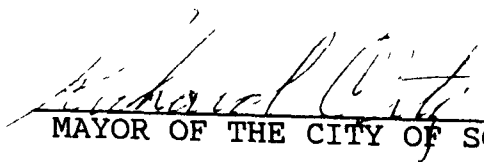
MAYOR OF THE CITY OF SOLEDAD

ATTEST:

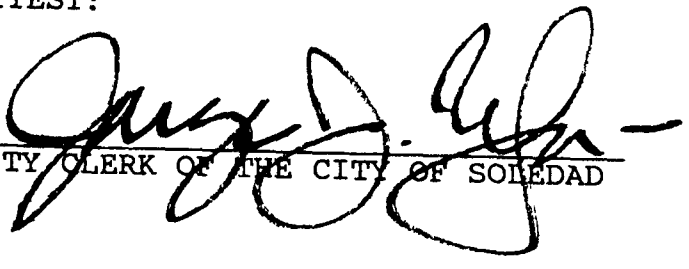
CITY CLERK OF THE CITY OF SOLEDAD

RINCON DE LA PUERTA DEL MONTE RO. 223-03

TAX CODE AREA

COUNTY OF MONTEREY ASSESSOR'S MAP BOOK 257 PAGE 02

T. 16. S, R. 6. E.

T. 17. S, R. 6. E.

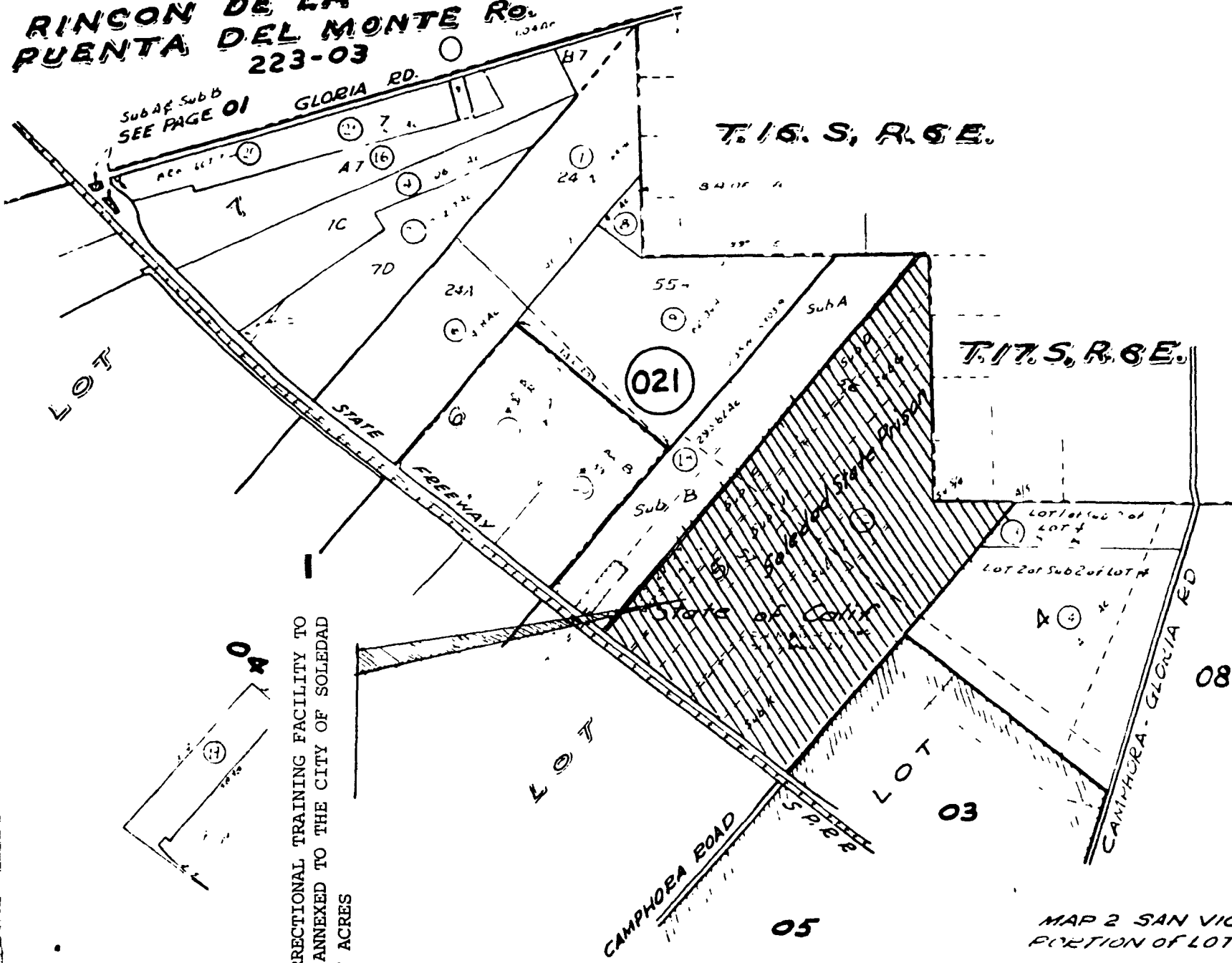

Scale 1/4" = 300 ft

EXHIBIT - A
CITY COUNCIL RESOLUTION
#1954
C.T.F. Annexation

CORRECTIONAL TRAINING FACILITY TO BE ANNEXED TO THE CITY OF SOLEDAD 997 ACRES

MAP 2 SAN VICENTE RO PORTION OF LOTS 5, 6, 7